

**Please, read this manual  
carefully before use!**

**Owner's Manual**



## **Gasoline brush cutter & string trimmer**

**KS BC16G-4T**

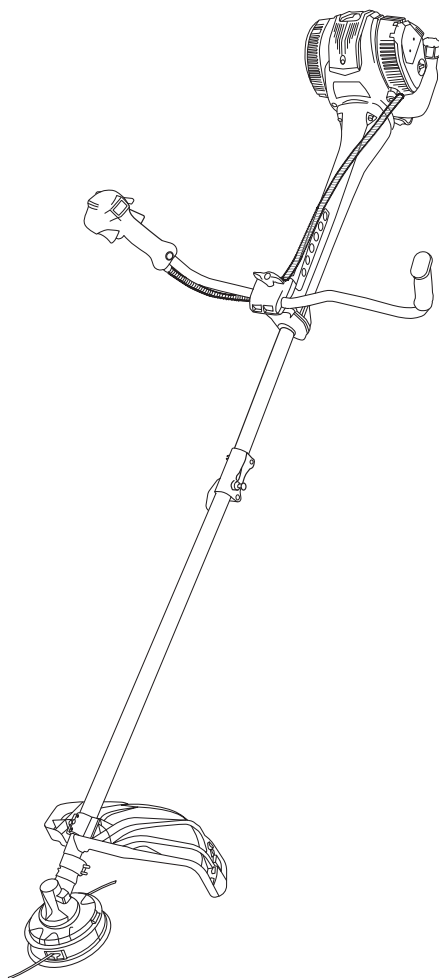



Thank you for choosing **Könnér & Söhnen®** products. This manual contains a brief description of safety, setup and use. More information can be found on the official importer's website in the support section: **[konner-sohnen.com/manuals](http://konner-sohnen.com/manuals)**

You can also go to the support section and download the manual by scanning the QR code or on the website of the official importer of **Könnér & Söhnen®** at **[www.konner-sohnen.com](http://www.konner-sohnen.com)**



*Please, read this manual  
carefully before use!*

The manufacturer of **Könnér & Söhnen®** products reserves the right to make changes that may not be reflected in this manual, namely:

- The manufacturer reserves the right to make changes in the product design, configuration and construction.
- The images and drawings in this manual are for reference only and may differ from the actual components and inscriptions on the products.

Contact information that you are free to use in case of any problems can be found at the end of this manual. All information in this user manual is up-to-date as of the time of publication. The current list of service centers can be found on the official importer's website at **[www.konner-sohnen.com](http://www.konner-sohnen.com)**



**ATTENTION – DANGER!**



**Failure to follow the recommendations marked with this sign may lead to serious injury or death of the operator or third parties.**



**IMPORTANT!**



**Useful information while operating the machine.**

## IMPORTANT SAFETY INFORMATION

**1**

### WORK AREA

- Keep the work area clean and well lit. Cluttered areas and poor lighting can lead to accidents.
- Do not operate trimmer in explosive atmospheres, such as in the presence of flammable liquids, gases or dust.
- Keep children or unauthorized individuals away from the work area, while working with trimmer. Distractions can cause you to lose control.
- Do not store or use trimmer in wet conditions (rain, snow). Water entering a power tool will increase the risk of electric shock.

### PERSONAL SAFETY

- Do not operate tool when you are tired or under the influence of drugs, alcohol or medication.
- Use safety equipment. Always wear eye protection. Safety equipment such as dust mask, non-skid safety shoes, hard hat, or hearing protection will reduce personal injuries.
- Do not overreach. Keep proper footing and balance at all times. This enables better control of the trimmer in unexpected situations.
- Do not wear loose clothing or jewellery, keep your hair, clothing and gloves away from moving parts. Loose clothes, jewellery or long hair can be caught in moving parts.

### POWER TOOL USE AND CARE

- Store idle trimmer out of the reach of children.
- Keep the trimmer in good working condition.

- Avoid unintentional starting.
- If there are any issues with the trimmer or it is not functioning properly, turn off the motor immediately.
- Switch off the trimmer when resting and when leaving the equipment unattended, and place it in a safe location to prevent danger to others or damage to the equipment.
- Do not apply excessive force to the tool. The job will be done better and more safely at the recommended speed of the tool.
- Don't overreach. Always keep proper footing and balance.

### CHECK BEFORE STARTING

- Before using the machine and after any impact, check for signs of wear or damage and repair as necessary.
- Inspect the working area. Remove all loose objects, such as stones, broken glass, nails, steel wire, string, etc. that could be thrown out or become wrapped around the cutter or cutter guard.

### PERSONAL SAFETY

- The cutting tool does not stop immediately after the machine is turned off.
- The machine is designed only for use as a brush cutter/grass trimmer. Do not use the brush cutter/grass trimmer for any purpose other than its intended use.
- Store the tool in a locked place, out of reach of children and unauthorized persons.
- Keep hands and feet away from the cutting tool, especially when the engine is running.
- Never start the engine inside a closed room or building. Exhaust gases contain dangerous carbon monoxide.
- Never use the product when the ground is slippery or when you can't maintain a stable position.
- Never use the device at night, during heavy fog, or in other conditions where your visibility is limited and it's difficult to clearly see the work area.
- Never use the device during heavy rain, thunderstorms, strong winds, or storms, as well as under any other weather conditions that may make using the device dangerous.

### POWER TOOL USE AND CARE

- Only use original spare parts.
- Always ensure that ventilation openings are kept clear of debris.
- All covers, guards and handles must be fitted before starting.
- Only use the machine in daylight or in other well-lit conditions.
- Never use the machine in bad weather, such as fog, rain, damp or wet conditions, strong winds, extreme cold, risk of lightning, etc. Extremely hot weather may cause the machine to overheat.

### FUELING SAFETY

- Pour fuel outdoors in areas free of sparks and flames. Use a container designed for fuel storage.
- Do not smoke or allow smoking near fuel or the trimmer while in use.
- Wipe up all fuel spills before starting the trimmer.
- Move 10 feet away from the fuel before starting the trimmer.
- Stop the engine before removing the fuel tank cap.

### MAINTENANCE SAFETY

- Disconnect spark plug before performing maintenance.

### TRANSPORT AND STORAGE SAFETY

- Let the engine cool down, empty the fuel tank, disconnect the shaft and move the handle to the transportation position along the shaft and secure the trimmer before storing or transporting in a vehicle.
- Empty the fuel tank before storing the trimmer. Store the trimmer and fuel in places where fuel vapors cannot reach sparks or open flames from appliances or electrical switches/engines.
- In case of long-term storage of the trimmer, clean the fuel tank after emptying it. Then start the engine and empty the carburetor of fuel.

Some of the following symbols may be used on this product. Please study them and learn their meaning. Proper interpretation of these symbols will allow you to operate the product better and safer.



**IMPORTANT!**



**If the warning seals become worn, peel off, or are soiled and unreadable, contact the dealer where you purchased the product to order new seals and place them in the appropriate places.**



**WARNING!**



**Never modify your machine. We do not provide a warranty for the device if you use a modified trimmer or fail to follow the correct operating procedures indicated in the manual.**



Read all safety warnings and all instructions. Failure to follow the warnings and instructions may result in electric shock, fire and/or serious injury.



Wear personal protective equipment. Basically, wear protective goggles or, even better, face protection, ear protection.



Beware of falling objects.  
Keep unauthorized persons away from the work area.



Keep the equipment away from nearby people (15 m).  
Keep unauthorized individuals away from the work area.



Do not use the machine in the rain or leave it outdoors when it is raining.



The hole for refueling the "GASOLINE"  
Position: FUEL TANK CAP



The direction to close the choke  
Position: AIR CLEANER COVER



The direction to open the choke  
Position: AIR CLEANER COVER



Keep away from fire.



Guaranteed sound power level.



This product must not be disposed of with regular domestic waste.

1. Starter
2. Fuel tank
3. Coupler
4. Stand
5. 4-Point anti-vibration system
6. Hanger
7. Tube
8. Safety guard
9. Trimmer head
10. Gear case
11. Throttle lever
12. Engine switch button
13. Handle
14. Throttle cable

### ACCESSORIES IN THE SET

17. Double shoulder strap
18. Face shield
19. Hearing protectors
20. Tool bag

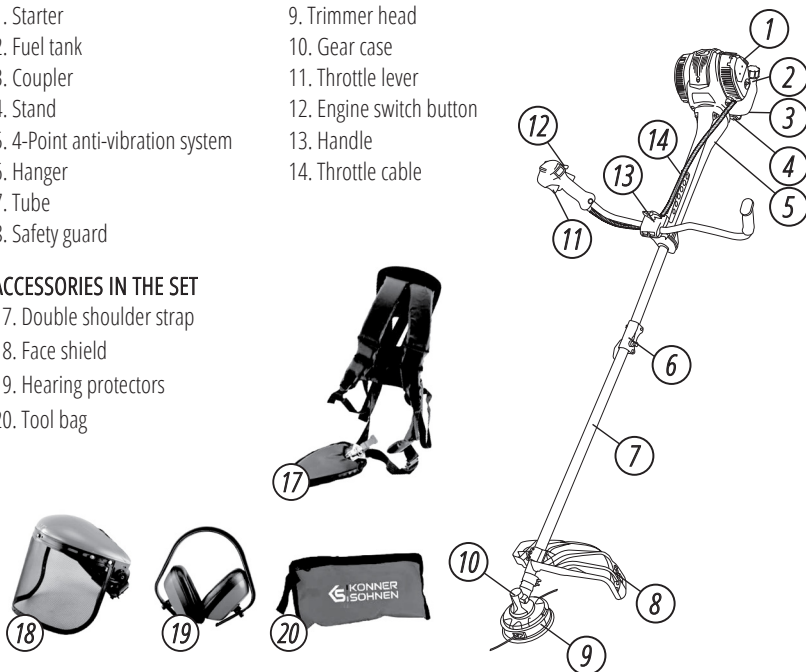

**IMPORTANT!**



The manufacturer reserves the right to make changes and/or improvements to the design, components, and technical attributes without notice or obligation. The pictures in this manual are schematical and may not match the parameters of original product.

## SPECIFICATIONS

## 5

Model	KS BC16G-4T
Rated output power	1,63 HP/ 1,2 kW
Engine displacement	38,9 cm <sup>3</sup>
Engine speed	9500 rpm
Engine model	KS 40
Tube diameter	28 mm
Cutting width	420 mm
3-segment blade diameter	255 mm
String diameter	up to 3,3 mm
Gross dimensions (L×W×H)	1050×280×293×80 mm
Net weight	7 kg

## Fig. 1 – Installing handle (loop handle)

Mount the handle to the shaft tube and secure it at a location that is comfortable to you.

## Fig. 2 – Installing handle

1. Loosen screw (1). Remove the clamping parts (2 and 4). Insert the handle tube (3) into the lower clamping part (4). Install the upper clamping part (2). Insert the spring (5) from below into the lower clamping part (4). Place the clamping parts (2 and 4) on the handle and tighten screw (1).
2. Rotate the handle tube (3) upwards and align it so that the distance (A) is approximately 15 cm. Do not clamp the handle tube (3) in the curved section.
3. Tighten the clamping screw (1).

## Fig. 3 – Connecting the throttle cable (if necessary)

1. Remove the air filter cover.
2. Connect the end of the throttle cable to the connector at the top of the carburetor.

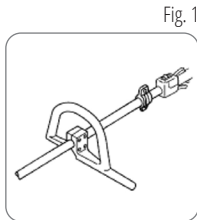

Fig. 1

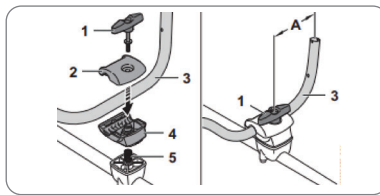

Fig. 2

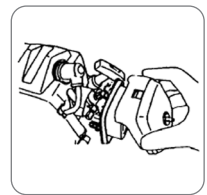

Fig. 3

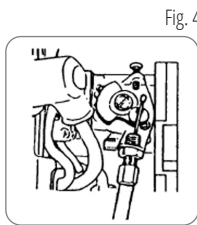

Fig. 4

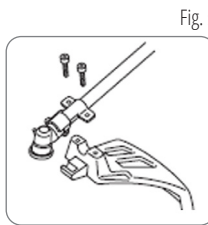

Fig. 5

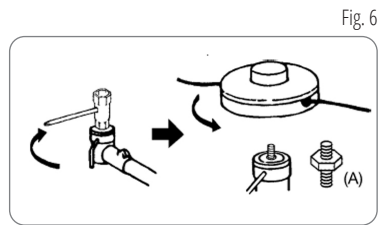

Fig. 6



NOTE



When installing the filter cover, make sure the highly tensioned wire is inside.

## Fig. 4 – Connecting switch wires (if necessary)

Connect the switch wires between the engine and the main unit. Pair the wires of the same color.

## Fig. 5 – Installing debris guard for trimmer head

Attach the debris guard with the bolts provided.

## Fig. 6 – Installing trimmer head

1. Fix the gearbox shaft by pressing the gearbox lock button, loosen and remove the bolt (left-handed).
2. Fit the trimmer head assembly to the gear shaft by using bolt (A). Hand tighten it securely.

## Fig. 7 – Installing the metal blade

1. Set the inner holder to the gear shaft, and turn to fix with the attached L-shaped bar.
2. Put the blade on the inner holder with letters to the gear case, and match correctly the hole of the blade to the projection of the inner holder.
3. Set the outer holder to the gear shaft with the hollowed face to the blade.

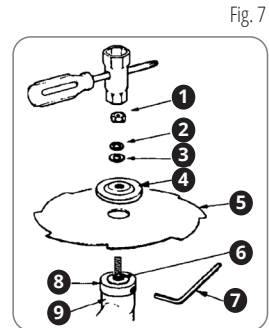

Fig. 7

1. Nut
2. Spring Washer
3. Washer
4. Outer holder
5. Blade
6. Gear shaft
7. Bar
8. Inner holder
9. Gear case

- Put the attached bolt cover on the outer holder and secure it with the bolt (left screw) together with the spring washer and the washer.

## Balance unit

- Put on the belt and secure the device to it.
- Move the clamp up or down until the device is balanced so that the working head does not touch the ground during use.

## FUEL AND OIL

7

- The engine of this device runs on pure gasoline, which is highly flammable. Never store fuel cans or refill the tank of the device in areas where there are boilers, stoves, wood fires, electrical sparks, welding sparks, or any other sources of heat or fire that could ignite the fuel.
- Never smoke while operating the unit or refilling its fuel tank.
- When refilling the tank, always turn off the engine and allow it to cool down. Take a careful look around to make sure that there are no sparks or open flames anywhere nearby before refueling.
- Wipe spilled fuel completely using a dry rag if any fuel spillage occurs during refueling.
- After refueling, tightly close the fuel tank cap, and then move the unit at least 3 meters away from the refueling area before starting the engine.

## FUELING THE UNIT (Fig. 8)



NOTE



**Check the fuel level by looking through the translucent fuel tank.**

- If the fuel level is low, refuel in a well-ventilated area with the engine stopped. If the engine has been running, let it cool down.
- Unscrew and remove the GASOLINE/OIL cap. Place the cap on a clean surface.
- Fill the tank with GASOLINE/OIL to 80% of its full capacity.
- Fasten the fuel cap securely and wipe up any fuel spillage around the unit.

Fuel filler cap

Fig. 8

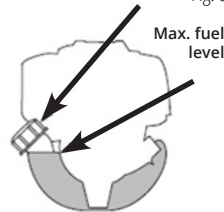

## ENGINE OIL

Oil is a major factor affecting performance and service life. Use 4-stroke automotive detergent oil. Use 4-stroke motor oil that meets or exceeds the API service requirements indicated on the container label, with a rating of SJ or later (for equivalent). SAE 10W-30 is recommended for general use. Other viscosities shown in the table may be used when the average temperature in your area is within the indicated range.

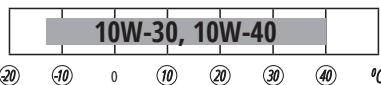
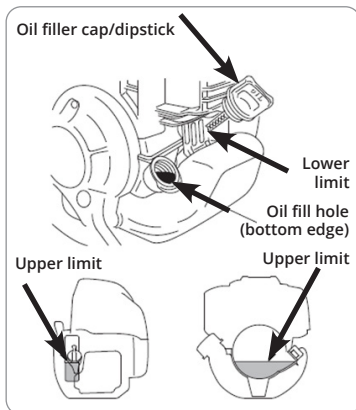

Fig. 9

## OIL LEVEL CHECK (Fig. 9)

Check the engine oil level before each use, or every 10 hours of continuous operation. Check the oil level with the engine stopped and the unit in a level position.

- Remove the oil filler cap/dipstick and wipe it clean.
- Insert and remove the oil filler cap/dipstick without screwing it into the oil filler neck, then remove it to check the oil level shown on the dipstick.
- If the oil level is near or below the lower limit mark on the dipstick, add oil up to the bottom edge of the oil fill hole with the recommended oil. To avoid overfilling or underfilling, be sure the engine is in a level position, as shown, while adding oil.
- Install the oil filler cap/dipstick and tighten it securely.



## OIL CHANGE (Fig. 10)

Fig. 10

Drain the used oil when the engine is warm. Warm oil drains quickly and completely.

1. Check that the fuel filler cap is tightened securely.
2. Place a suitable container below the engine to catch the used oil.
3. Remove the oil filler cap/dipstick and drain the oil into the container by tilting the engine toward the oil filler neck.

Please, dispose of used motor oil in a manner that is compatible with the environment. We recommend taking used oil in a sealed container to your local recycling center or service station for proper disposal. Do not throw it in the trash, pour it on the ground, or dispose of it down a drain.

4. With the engine in a level position, fill to the bottom edge of the oil fill hole with the recommended oil.

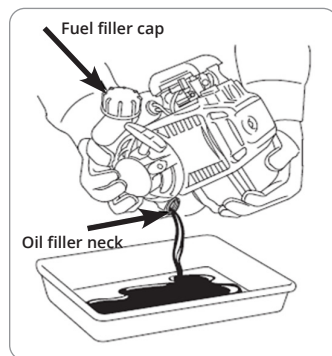

**WARNING!**



1. Choose an open area for refueling.
2. Move at least 10 feet (3 meters) away from the fueling point before starting the engine.
3. Stop the engine before refueling the unit. At that time, be sure to sufficiently mix the fuel mixture in the container.

## FOR PROLONGED ENGINE LIFE, AVOID:

1. **LACK OF LUBRICATION** – This will quickly lead to serious damage to the engine internal components.
2. **USE OF GASOLINE** – This can cause damage to rubber and/or plastic parts and disrupt engine lubrication.
3. **USING OIL FOR WATER-COOLED ENGINES** – This may lead to spark plug fouling, exhaust port blockage, or piston ring sticking.

## BEFORE STARTING THE ENGINE

8

- Consider the area within a 15-meter radius around the operator as a danger zone, where no one should enter while the trimmer is in operation. If necessary, set up yellow caution tape and warning signs. If multiple people are working simultaneously, always check the positions of others to ensure a safe distance.
- Check the work area for hidden obstacles, such as stumps, stones, cans, glass, etc., and remove them before starting work to avoid any accidents.



**IMPORTANT!**



**Remove any obstacle before beginning work.**

- Inspect the entire unit for loose fasteners and fuel leakage. Make sure that the cutting attachment is properly installed and securely fastened.
- Be sure the debris guard is securely fastened in place.
- Always use the shoulder strap. Adjust it for comfortable use before starting the engine. The strap should be adjusted so that your left hand can comfortably hold the handlebar grip at approximately waist level.

## STARTING THE ENGINE

- Keep bystanders and animals at least 15 m (50 ft) away from the operating point. If someone approaches, immediately stop the engine.
- The device is equipped with a centrifugal clutch mechanism, so the cutting attachment begins to rotate as soon as the engine is started by putting the throttle into the start position. When starting the engine, place the product onto the ground in a flat clear area and hold it firmly in place so as to ensure that neither the cutting part nor the throttle come into contact with any obstacle when the engine starts.





**WARNING!**



**Never place the throttle into the high-speed position when starting the engine.**

- After starting the engine, check to make sure that the cutting attachment stops rotating when the throttle is moved fully back to its original position. If it continues to rotate even after the throttle has been moved fully back, turn off the engine and take the unit to your authorized servicing dealer for repair.

**Hot restart:** If the engine has been running at high temperatures and then turned off and left off for a while, follow the special procedures for restarting.

## DANGER DURING OPERATION

9



**IMPORTANT!**



**Cut only materials recommended by the manufacturer. And use only for tasks explained in the manual.**

- Grip the handles firmly with both hands using your whole hand. Place your feet slightly apart (slightly further apart than the width of your shoulders) so that your weight is distributed evenly across both legs, and always be sure to maintain a steady, even position while working.
- Keep cutting attachment below waist level.
- Maintain the speed of the engine at the level required to perform cutting work, and never raise the speed of the engine above the necessary level.
- If the unit starts to shake or vibrate, turn off the engine and check the whole unit. Do not use it until the trouble has been properly corrected.
- Keep all parts of your body away from rotating cutting attachment and hot surfaces.
- Never touch the muffler, spark plug, or other metallic parts of the engine while the engine is in operation or immediately after shutting down the engine. Doing so could result in serious burns or electrical shock.

### IF SOMEONE APPROACHES

- Always avoid dangerous situations. Warn adults to keep pets and children away from the area. Be careful if someone approaches you. Injury may result from flying debris.
- If someone calls or distracts you while working, make sure to turn off the engine before turning around.

## OPERATION

10

### STARTING ENGINE



**WARNING!**



**The cutting head will start rotating when the engine starts.**

1. Fill the fuel tank with fuel and securely tighten the cap.
2. Place the device on a flat, solid surface. Keep the cutting head raised off the ground and clear of surrounding objects, as it will begin rotating when the engine starts (Fig. 14).
3. Press the priming pump several times until fuel begins to flow from the tube.
4. Move the choke lever to the closed position (Fig. 11).
5. Set the ignition switch to the "I" position (Fig. 12). Set the throttle lever to the start position (1→2→3). Place the unit on a flat, firm place. Keep the cutting head clear of everything around it.
6. While holding the unit firmly (Fig. 13), pull out the starter rope until engine starts.

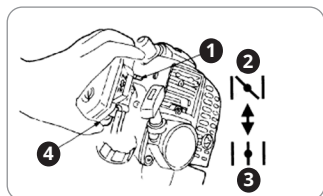

Fig. 11

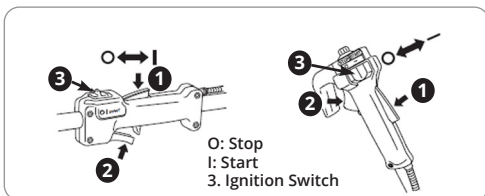

Fig. 12



Fig. 13

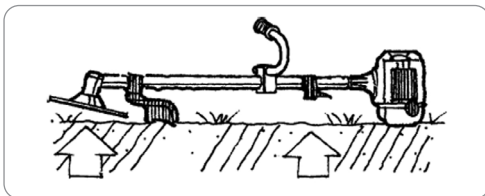

Fig. 14



**WARNING!**



The product is equipped with a centrifugal clutch mechanism, so the cutting attachment begins to rotate as soon as the engine is started by putting the throttle into the start position. When starting the engine, place the product onto the ground in a flat clear area and hold it firmly in place so as to ensure that neither the cutting part nor the throttle come into contact with any obstacle when the engine starts (Man. 14).



**IMPORTANT!**



Avoid pulling the rope all the way out or letting it retract by releasing the knob. Such actions can cause starter failures.

7. Move the choke lever downward to open the choke. And restart engine.
8. Allow the engine to warm up for a several minutes before starting operation.



**NOTE**



1. When restarting the engine immediately after stopping it, leave the choke open.
2. A throttle that is not opened in time can make the engine hard to start due to an excess of fuel. If the engine failed to start after several attempts, open the choke and repeat pulling the rope, or remove the spark plug and dry it.

## EQUIPPING THE SHOULDER STRAP (Fig. 15)

Fig. 15

1. Secure the shoulder strap in the appropriate place.
2. Turn on the engine, return the throttle lever to the lowest speed position, and hook the strap onto the hanging attachment point on the machine.
3. Adjust the length of the shoulder strap so that the blade is parallel to the ground in the working position. To prevent slack during operation, secure the excess strap with the buckle.

1. For branches and trees
2. For grass and weeds
3. Direction of cutting
4. Direction of rotation

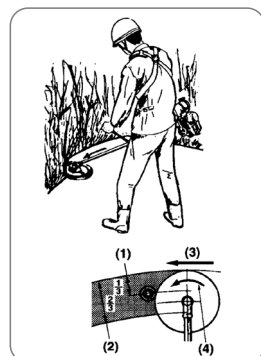

## STOPPING ENGINE (Fig. 16)

Fig. 16

1. Release the throttle lever and run the engine for half a minute.
2. Shift the ignition switch to the STOP position.

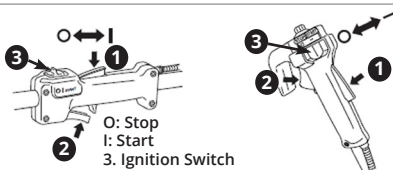

**IMPORTANT!**



Except in an emergency, avoid stopping the engine while pulling the throttle lever.

## IDLING SPEED ADJUSTMENT (Fig. 17)

Fig. 17

1. If the engine tends to stop frequently at idling mode, turn the adjusting screw clockwise.
2. If the cutting head keeps rotating after releasing the trigger, turn the adjusting screw counter-clockwise.

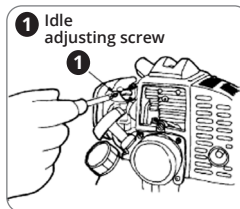
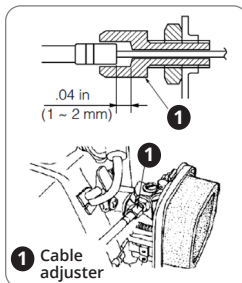

Fig. 18



## THROTTLE CABLE ADJUSTMENT (Fig. 18)

The normal play is 1 or 2 mm when measured at the carburetor side end. Readjust with the cable adjuster if required.

## CUTTER APPLICATION CHART

Replace with a suitable recommended cutting attachment depending on the object to be cut. When replacing the blade, always ensure you are using certified products.



**WARNING!**



When sharpening, removing, or reattaching the blade, be sure to wear thick, sturdy gloves and use only the proper tools and equipment to prevent injury.

## METAL BLADE USAGE

1. Check the bolt that fastens the blade and ensure that it is free from defects and wear.
2. Make sure that the blade and the holder have been fastened according to instruction and the blade turns smoothly without abnormal noise.



**WARNING!**



Improperly secured rotating parts can cause serious accidents for the operator. Make sure that the blade is not bent, warped, cracked, broken or damaged. If you find any defects on the blade, discard it and replace it with a new, certified one.

Using the shoulder strap, hang the unit on your right side. Adjust the strap length so that the cutting head may become parallel to the ground.



**WARNING!**



**Make sure to use shoulder strap and protection guard. Otherwise, it can be very dangerous if you slip or lose your balance.**

## CUTTING METHOD (Fig. 15)

1. Use the front left side for cutting.
2. Guide the blade from the right to the left side, slightly tilting it to the left.
3. When mowing a large area, start from the left edge to avoid the cut grass interfering with your work.
4. The blade can get caught in weeds if the engine speed is too low or the blade penetrates too deeply into the weeds. Adjust the engine speed and cutting depth according to the condition of the material being cut.

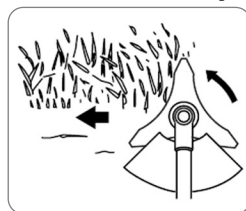

Fig. 15



**WARNING!**



**If the grass or other object gets caught in the blade, or if the unit starts to shake or vibrate, turn off the engine and check the whole unit. Change the blade if it has been damaged.**

Turn off the engine and make sure the blade has completely stopped before checking the blade, and removing any object got caught in.

## TRIMMER KICKBACK CONTROL

Trimmer kickback can cause serious injuries. Carefully review this section. It is important to understand what causes the trimmer blade to kick back, how to reduce the chances of this happening, and how to maintain control of the device if kickback occurs.

### 1. What causes kickback:

Kickback can occur when the moving blade contacts an object that it cannot cut. This contact causes the blade to stop for a moment and then suddenly move or “bounce” away from the object it hit. The operator can lose control of the unit and the blade can cause serious personal injury to the operator or any person nearby if the blade contacts any part of the body.

### 2. How you can reduce the chance of kickback:

- a. Recognize that kickback can happen. By understanding and knowing about bounce, you can help eliminate the element of surprise.
- b. Cut fibrous weeds and grass only. Do not let the blade contact materials it cannot cut such as hard, woody vines and brush or rocks, fences, metal, etc
- c. Be especially prepared for rebound if you need to cut in areas where you cannot see how the blade is making contact, such as in areas of dense vegetation.
- d. Keep the blade sharp. A dull blade increases the chance of bounce.
- e. Avoid feeding the blade too rapidly. The blade can bounce away from the material being cut if the blade is fed faster than its cutting capability.
- f. Cut only from right to left.
- g. Keep your path clear of cut material and other debris.

### 3. How you can maintain the best control:

- a. Keep a good, firm grip on the unit with both hands. A firm grip can help neutralize bounce. Keep your right and left hands completely around the respective handles.
- b. Keep both feet spread apart in a comfortable stance, but be ready for the possibility that the unit could bounce. Do not overreach. Keep firm footing and balance.

## CUTTING (USING THE TRIMMER HEAD)



**WARNING!**



1. Always wear eye protection such as safety goggles. Never lean over the rotating cutting head. Rocks or other debris could be thrown into eyes and face and cause serious personal injury.
2. Always keep the protective guard in place when the device is in operation.

### TRIMMING GRASS AND WEEDS (Fig. 16)

Always remember that the TIP of the line does cutting. You will achieve better results by not crowding the line into the cutting area. Let the unit trim at its own pace.

1. Hold the unit so the head is off the ground.
2. You can avoid thrown debris by moving from left to right.
3. Use slow, deliberate movements to cut dense vegetation. The cutting speed will depend on the material being cut. Dense growth requires slower motion than light growth.
4. Never swing the unit so hard that you are in danger of losing your balance or control of the unit.
5. Try to control the cutting motion with the hip rather than placing the full workload on the arm and hands.
6. Take precautions to avoid wire, grass and dead, dry, long-stem weeds from wrapping around the head shaft. Such materials can stop the head and cause the clutch to slip, resulting in damage to the clutch system if repeated frequently.

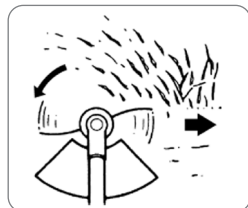

Fig. 16

### ADJUSTING THE LINE LENGTH

If your brush cutter is equipped with a semi-auto nylon line head that allows the operator to advance the line without stopping the engine, lightly tap the head on the ground when the line becomes short, while running the engine at full throttle.

Each time the head is bumped, the line advances about 25 mm. For better effect, tap the head on bear ground or hard soil. Avoid bumping in thick, tall grass, as this may cause the engine to stop due to overload.

Always remember that the TIP of the line does cutting. You will achieve better results by not crowding the line into the cutting area. Let the unit trim at its own pace.

## MAINTENANCE

11

1. In order to maintain your product in proper working condition, perform the maintenance and inspection operations described in the manual at regular intervals.
2. Always be sure to turn off the engine before performing any maintenance or checking procedures.



**WARNING!**



**The metallic parts reach high temperatures immediately after stopping the engine.**

3. When replacing the cutting attachment or any other part, or when replacing the oil or any lubricant, always be sure to use manufacturer product.
4. In case any part needs to be replaced or any maintenance or repair work not described in this manual must be performed, please contact a representative of the nearest authorized service dealer for assistance.
5. Under no circumstances should you disassemble or modify the product in any way. Doing so might result in the product becoming damaged during operation or the product becoming unable to operate properly.

	System/Components	Procedure	Before use	First month or 10 operating hours after	Every 25 operating hours after	Every 50 operating hours after	Every 100 operating hours after	Note
ENGINE	Fuel leaks, fuel spillage	Wipe out	✓					
	Engine oil	Check the level	✓					
		Replace		✓		✓		
	Fuel tank, air filter, fuel filter	Inspect/Clean	✓		✓			Replace if necessary
	Idle adjusting screw	See adjusting idling speed	✓					Replace carburetor if necessary
	Spark plug	Clean and readjust plug gap				✓		GAP: 0.25 in (0.6 – 0.7mm) replace if necessary
	Cylinder fins, intake air cooling vent	Clean			✓			
SHAFT	Muffler, spark arrester, cylinder exhaust port	Clean				✓		
	Throttle lever, ignition switch	Check operation	✓					
	Cutting parts	Replace if something's wrong	✓					
	Gear case	Grease			✓			
	Screws/Nuts/Bolts	Tighten/Replace	✓				✓	not adjusting screws
	Debris guards	Make sure to attach	✓					

## BLADE

Check the blade and the fasteners for looseness, cracks, or bending. Inspect the cutting edges and reshape with a flat file.

### Tips:

1. Keep the cutting edge sharp.
2. Round the base of the edge using a round file.
3. Do not use water when grinding.



**IMPORTANT!**



It is recommended that filing should be done by professionals. Especially regarding filing the saw blade, leave it to the professionals.

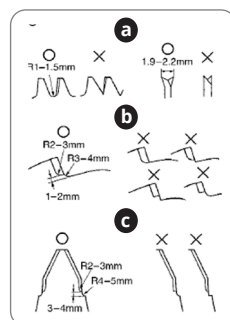

a) Saw blade b) 8-teeth blade  
c) 3-teeth blade



**WARNING!**



Make sure that the engine has stopped and is cool before performing any service to the machine. Contact with moving cutting head or hot muffler may result in a personal injury.

## AIR FILTER (Fig. 17)

The air filter, if clogged, will reduce the engine performance. Check and clean the filter element in warm, soapy water as required. Dry completely before installing. If the element is broken or has shrunk, replace with a new one.

## FUEL FILTER (Fig. 18)

When the engine loses fuel supply, check the fuel cap and fuel filter for any blockages.

## SPARK PLUG (Fig. 19)

Starting failures and misfires are often caused by a fouled spark plug. Clean the spark plug and check that the gap is within the specified range. For replacement, use the specified type of spark plug.

Fig. 17

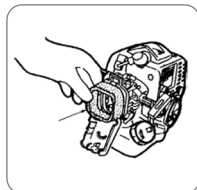

Fig. 18

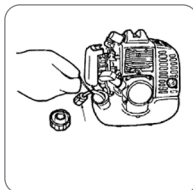
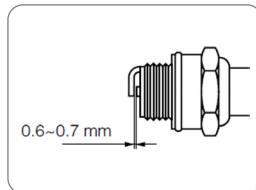

Fig. 19



**IMPORTANT!**



**Note that using any spark plug other than the designated type may result in improper engine operation, overheating, and potential damage. To install the spark plug, first tighten it by hand until it is snug, then tighten it a quarter turn more with a socket wrench.**

## MUFFLER



**WARNING!**



**Periodically inspect the muffler for loose fasteners, damage, or corrosion. If any signs of exhaust leakage are found, stop using the machine and have it repaired immediately.**

Note that failure to follow this recommendation may result in engine fire.

Fig. 20

## GEARBOX (Fig. 20)

The reduction gears are lubricated with multipurpose lithium-based grease in the gearbox. Add fresh grease every 25 hours of use, or more frequently depending on operating conditions.



## INTAKE AIR COOLING VENT (Fig. 21)



**WARNING!**



**Never touch the cylinder, muffler, or spark plugs with your bare hands immediately after stopping the engine. The engine can become very hot during operation, and doing so could result in severe burns.**

When checking the machine to make sure that it is in proper working condition before using it, check the area around the muffler and remove any wood chips or leaves stuck to the brush cutter. Failing to do so could cause the muffler to overheat, which could, in turn, cause the engine to catch fire. Always make sure that the muffler is clean and free of wood chips, leaves, and other waste before use.

Check the intake air cooling vent and the area around the cylinder cooling fins after every 25 hours of use for blockage, and remove any waste stuck to the brush cutter. Note that it is necessary to remove the engine cover to view the upper part of the cylinder.

Fig. 21

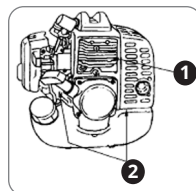

**1. Cylinder**

**2. Intake air cooling vent**



**IMPORTANT!**



**If waste gets stuck and causes blockage around the intake air cooling vent or between the cylinder fins, it may cause the engine to overheat, and that in turn may cause mechanical failure on the part of the brush cutter.**

## PROCEDURES TO BE PERFORMED AFTER EVERY 100 HOURS OF USE (Fig. 22)

Fig. 22

1. Remove the muffler, insert a screwdriver into the vent, and wipe away any carbon buildup. Wipe away any carbon buildup on the muffler exhaust vent and cylinder exhaust port at the same time.
2. Tighten all screws, bolts, and fittings.
3. Check for any oil or grease leakage between the clutch lining and the drum. If there is a leak, clean it using lead-free, oil-free gasoline.

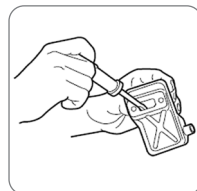

## STORAGE

12

Aged fuel is one of major causes of engine starting failure. Before storing the unit, empty the fuel tank and run the engine until it uses all the fuel left in the fuel line and the carburetor. Store the unit indoor taking necessary measures for rust prevention.

## TROUBLESHOOTING GUIDE

13

### CAUSE 1. STARTING FAILURE

Check	Possible causes	Corrective action
<b>Fuel tank</b>	Incorret fuel	Drain it and use correct fuel
<b>Fuel filter</b>	Fuel filter is clogged	Clean
<b>Carburetor adjustment screw</b>	Out of normal range	Adjust to normal range
<b>Sparking (no spark)</b>	Spark plug is fouled/wet	Clean/Dry
	Plug gap is incorrect	Correct (GAP: 0.6 ~ 0.7 mm)
<b>Spark plug</b>	Disconnected	Retighten

### CAUSE 2. ENGINE STARTS BUT DOES NOT KEEP RUNNING/HARD TO RESTART

Check	Possible causes	Corrective action
<b>Fuel tank</b>	Incorret fuel or staled fuel	Drain it and use correct fuel
<b>Carburetor adjustment screw</b>	Out of normal range	Adjust to normal range
<b>Muffler, cylinder (exhaust port)</b>	Carbon is built-up	Wipe away
<b>Air cleaner</b>	Clogged with dust	Wash
<b>Cylinder fin, fan cover</b>	Clogged with dust	Clean



The international manufacturer warranty is 1 year. The limited warranty starts from the date of retail purchase by the end-user. Make sure to keep your receipt during the whole warranty period. This product is not intended for commercial use. The warranty doesn't cover: chargers for Lithium batteries, bulbs, fuses, accessories as well as normal wear and other exclusions listed below (which applicable for this group of products). This product is not intended for commercial use.

Replaced parts will be considered part of the original product, and the warranty on those parts will expire simultaneously with the original product warranty.

The warranty period begins when the product is delivered to the purchaser. This warranty is non-transferable, it's valid to the original purchaser only. Könnér & Söhnen may choose to repair, replace or refund the power equipment at its sole discretion.

### WARRANTY EXCLUSION

- The user has failed to comply with the instructions in this manual.
- The product features damaged or missing identification stickers or labels, serial numbers, etc.
- Product malfunction was due to improper transportation, storage and maintenance.
- In case of mechanical damages (cracks, chips, impact and fall marks, deformation of housing, power cord, plug or any other components), provided there are foreign objects inside the unit.
- Proper operation of the product can be restored following cleaning from dust and dirt, appropriate adjustment, maintenance, etc.
- Faults have been caused by product overload.
- If electrical cables or plugs show signs of mechanical or thermal damage.
- In the event of foreign liquids and objects, metal chips, etc. inside the product are found.
- The damage caused by natural factors such as dirt, dust, humidity, high or low temperature, failures due to acts of God or natural disasters, which are beyond manufacturer's control (such as earthquake, tornado, fire, war, earthquake, etc.)
- Normal wear parts and accessories (fuses, bulbs, keys, buttons, plastic and rubber parts, chargers for Lithium batteries, filters and consumables, etc., as well as normal wear)
- Preventive maintenance (cleaning, washing), installation and adjustment.
- The product was modified or altered.
- In case of malfunctions resulting from normal wear and tear as a result of long-term use (end of life), cosmetic defects.
- Product operation was not stopped and continued after detecting a malfunction.



# EC Declaration of Conformity

Nr. 223

The following products have been tested by us with the listed standards and found in compliance with the European Community Machinery Directive 2006/42/EC, Electromagnetic compatibility Directive (EMC) 2014/30/EC, Noise Directive 2000/14/EC.

Manufacturer: DIMAX INTERNATIONAL GmbH  
Address: Flinger Broich 203, 40235 Duesseldorf, Germany  
Product: Gasoline brush cutter and string trimmer "Könner & Söhnen"  
Type / Model: KS BC16G-4T, KS BC17G-2T, KS BC19G-2T

The statement is based on a single evaluation of above mentioned products. It does not imply an assessment of the whole production and does not permit the use of the test lab. logo. The manufacturer should ensure that all product in series production are in conformity with the product sample detailed in this report. The applicant should hold the whole technical report at disposal of the competent all the right.

Applied EC Directives: 2006/42/EC Machinery Directive  
2000/14/EC Noise Directive  
2014/30/EC Electromagnetic compatibility Directive  
(EU) 2016/1628 Non-Road mobile machinery emissions

Applied Standards: EN ISO 11806-1:2022  
ISO 22868:2021  
ISO 12100:2010,6.4  
EN ISO 14982:2009

## 2000/14/EC\_2005/88/EC Annex VI

For model KS BC16G-4T  
Noise measured Lwa = 105 dB (A), guaranteed Lwa = 107 dB (A),  
For models KS BC17G-2T, KS BC19G-2T  
Noise measured Lwa = 107 dB (A), guaranteed Lwa = 110 dB (A).

Gasoline engine KS 40, KS 45, KS 55 correspond to European Emission Standard Euro 5 (STAGE V). This is confirmed by EU TYPE-APPROVAL CERTIFICATE issued by the government of Luxemburg, Ministry of Mobility and Public Works of Luxembourg, Department of Mobility and Transport. Technical service responsible for carrying out the test - IDIADA.  
Date of issue 28/01/2019



24

**Issued Date:** 2025-03-15  
**Place of issue:** Duesseldorf  
**Director:** Fomin P.

**DIMAX**

International GmbH  
Flinger Broich 203 40235 Düsseldorf  
USt-ID DE296177274  
koenner-soehnen.com

*P. Fomin*

We DIMAX INTERNATIONAL GmbH hereby declare that specified above conforms covering European Parliament and Council Directives, 2006/42/EC of 17 May 2006 Machinery Directive, Electromagnetic compatibility Directive (EMC) 2014/30/EC of 26 February 2014, Noise Directive 2000/14/EC of 8 May 2000. The CE mark above can be used under the responsibility of manufacturer. After completion of an EC declaration of Conformity and compliance with all relevant EC directives.

## CONTACTS

**Deutschland:**

Hergestellt unter Lizenz und Kontrolle der DIMAX International GmbH.

Importeur und Vertreter in Deutschland:  
DIMAX International GmbH Flinger Broich 203, 40235  
Düsseldorf, Deutschland. Produziert in VRC.

innovationtrade8@gmail.com

[www.konner-sohnen.com/de](http://www.konner-sohnen.com/de)

---

**European Union:**

Manufactured under license and control of DIMAX International GmbH, Flinger Broich 203, 40235 Düsseldorf, Germany.

Importer and representative in Netherlands DIMAX International Poland Ltd, Południowa 8 st, 05-0830 Stara Wies, Poland. Assembled in PRC.

innovationtrade8@gmail.com

[www.konner-sohnen.com](http://www.konner-sohnen.com)

---

**The United Kingdom:**

Innovation Trade Ltd., 63/66 Hatton Garden Fifth Floor, Suite 23, London, EC1N 8LE, info.uk@dimaxgroup.de

**Technical support**

support.uk@dimaxgroup.de

[konner-sohnen.com/en-gb](http://konner-sohnen.com/en-gb)

---

**France:**

Fabriqué sous licence et contrôle de DIMAX International GmbH, Flinger Broich 203, 40235 Düsseldorf, Allemagne.

Importateur et représentant en France et en Belgique  
DIMAX International Poland Ltd, Południowa 8 st, 05-0830 Stara Wies, Pologne. Assemblé en RPC.

innovationtrade8@gmail.com

[www.konner-sohnen.com/fr](http://www.konner-sohnen.com/fr)

---

**España:**

Fabricado bajo licencia y control de DIMAX International GmbH, Flinger Broich 203, 40235 Düsseldorf, Alemania.

Importador y representante en España de DIMAX International Poland Ltd, Południowa 8 st, 05-0830 Stara Wies, Polonia.

Ensamblado en la República Popular China.

innovationtrade8@gmail.com

[www.konner-sohnen.com/es](http://www.konner-sohnen.com/es)

---

**Polska:**

Wyprodukowano na licencji i pod kontrolą DIMAX International GmbH, Flinger Broich 203, 40235 Düsseldorf, Niemcy.

Importer i przedstawiciel w Polsce:

DIMAX International Poland Sp. z o. o. ul. Południowa 8, 05-0830 Stara Wies, Polska. Zmontowany w CRL.

innovationtrade8@gmail.com

[www.konner-sohnen.com/pl](http://www.konner-sohnen.com/pl)

---

**Україна:**

Виготовлено за ліцензією та під контролем DIMAX International GmbH, Flinger Broich 203, 40235 Дюссельдорф, Німеччина.

Імпортёр та представник в Україні:

ТОВ "ТЕХНО ТРЕЙД КС" вул. Електротехнічна 47, 02232, м. Київ, Україна. Змонтовано в КНР

[www.konner-sohnen.com/ua](http://www.konner-sohnen.com/ua)